

SEE SHEET 23

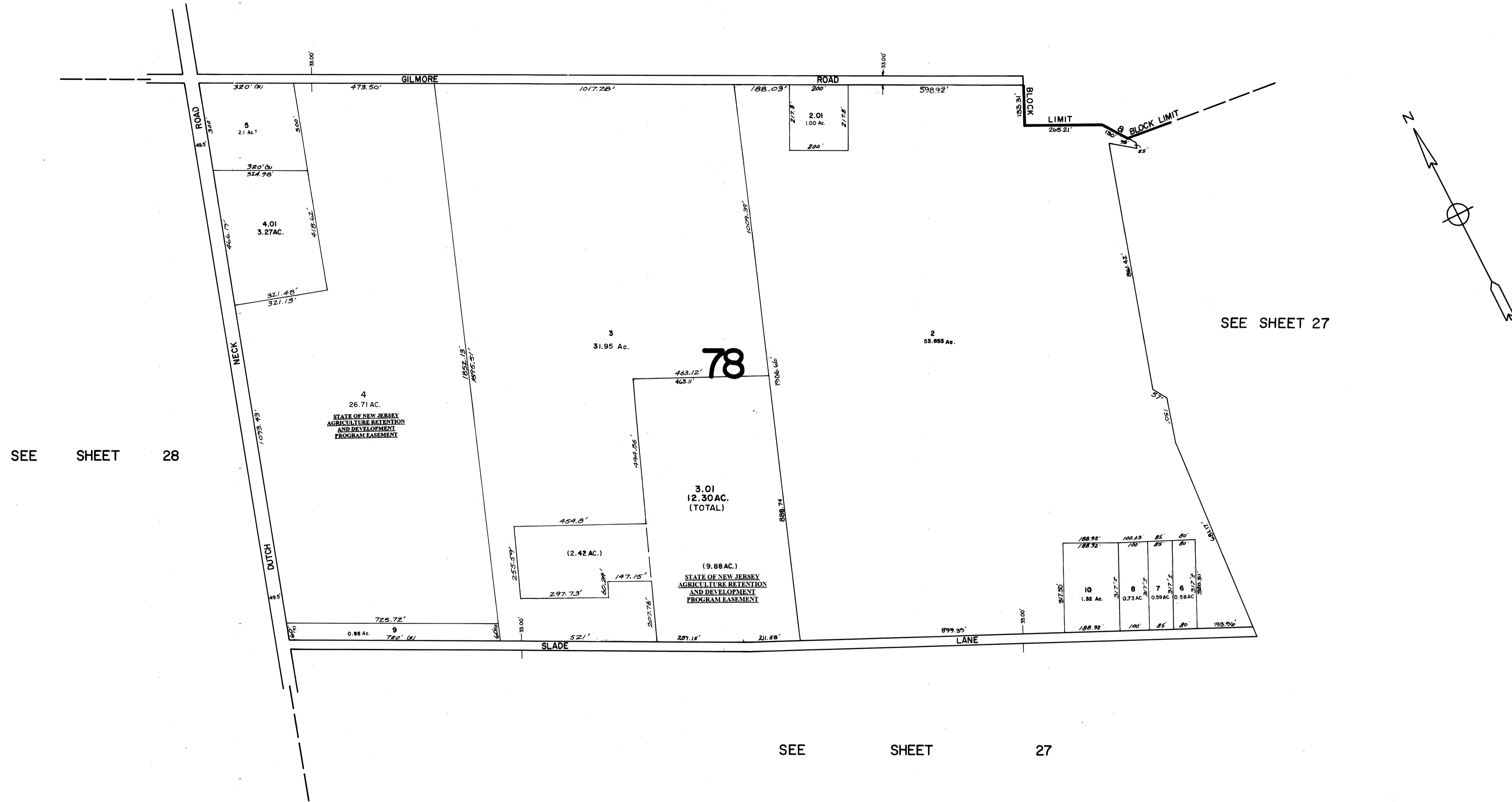

SEE SHEET 28

SEE SHEET 27

SEE SHEET 27

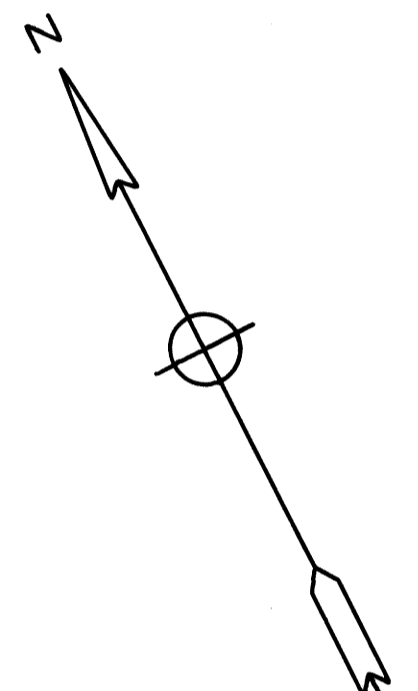

**TAX ASSESSMENT MAP  
HOPEWELL TOWNSHIP  
CUMBERLAND COUNTY N.J.**

SCALE: 1" = 200'  
MAY, 1976  
ALBERTA. FRALINGER JR., CONSULTING ENGINEER  
629 SHILOH PIKE, BRIDGETON, N. J. 08302

NEW JERSEY DEPARTMENT OF THE TREASURY  
DIVISION OF TAXATION  
LOCAL PROPERTY AND PUBLIC UTILITY BRANCH  
APPROVED AS A TAX MAP PURSUANT TO THE  
PROVISIONS OF CHAPTER 175, LAWS OF 1913, ETC.  
FOR THE DIRECTOR, DIVISION OF TAXATION  
*Alberta Fralinger Jr.*  
BY: P.E. & L.S. CHIEF  
LIC. # 5009  
DATE: JUL 26 1976 SERIAL NO. 557